

| REV. | DATE     | DESCRIPTION           |
|------|----------|-----------------------|
| A    | 06/05/03 | UPDATE DRAWING FORMAT |

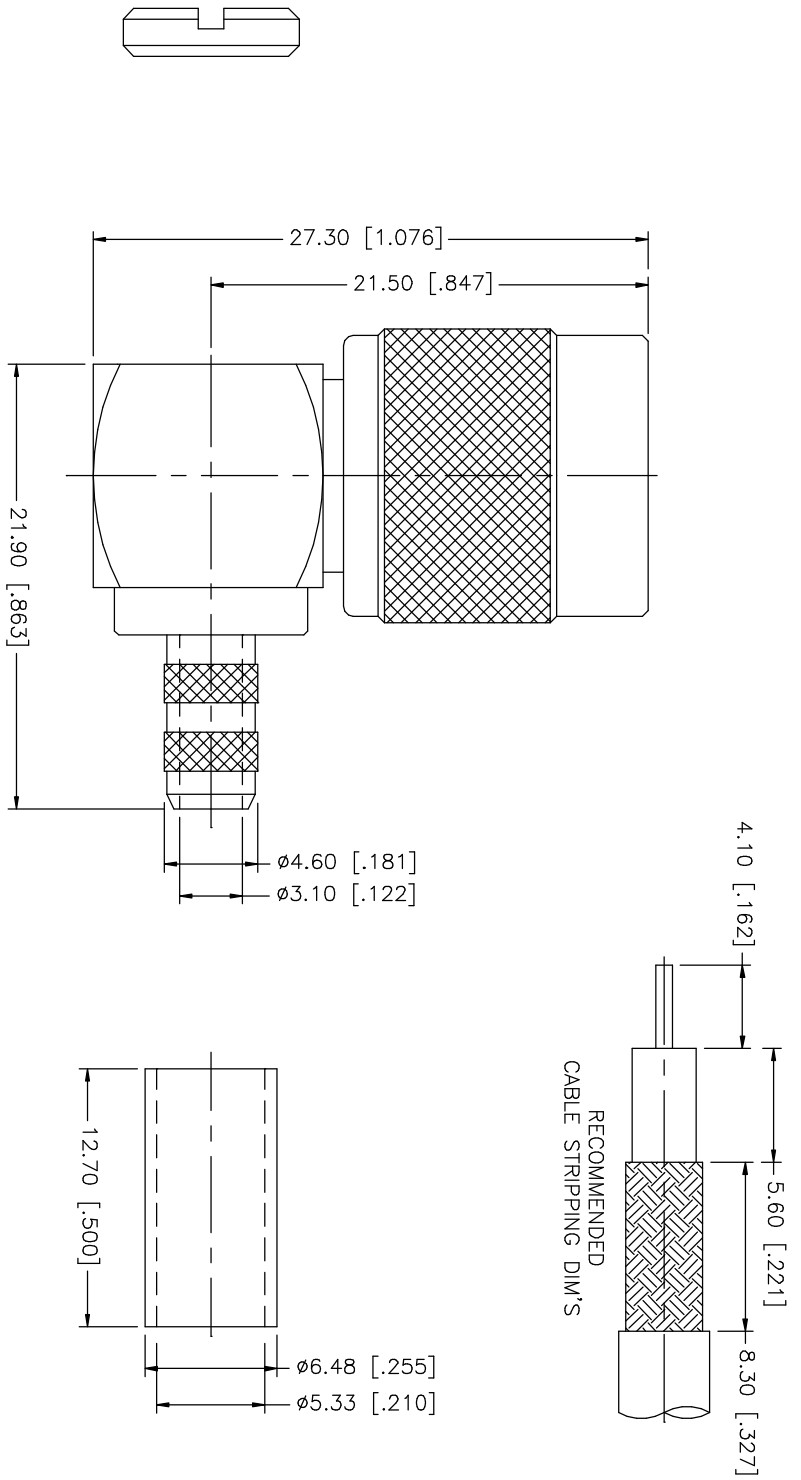

| REV. | DATE | DESCRIPTION |
|------|------|-------------|
| 8    |      |             |
| 7    |      |             |
| 6    |      |             |
| 5    |      |             |
| 4    |      |             |
| 3    |      |             |
| 2    |      |             |
| 1    |      |             |

| DESCRIPTION | MATERIAL | FINISH  | QTY |
|-------------|----------|---------|-----|
| 1           | BRASS    | NICKEL  | 1   |
| 2           | DELIRIN  | NATURAL | 1   |
| 3           | BRASS    | NICKEL  | 1   |
| 4           | BRASS    | NICKEL  | 1   |
| 5           | BRASS    | NICKEL  | 1   |
| 6           | BRASS    | NICKEL  | 1   |
| 7           | BRASS    | NICKEL  | 1   |
| 8           | BRASS    | NICKEL  | 1   |

| UNLESS OTHERWISE SPECIFIED DIMENSIONS ARE IN MILLIMETERS (INCHES ARE FOR CUSTOMER REFERENCE ONLY) |
|---------------------------------------------------------------------------------------------------|
| UNLESS OTHERWISE SPECIFIED TOLERANCES FOR MILLIMETERS ARE:                                        |
| 0.3 - 8mm ± 0.20mm                                                                                |
| 8 - 30mm ± 0.40mm                                                                                 |
| 30 - 120mm ± 0.50mm                                                                               |
| UNLESS OTHERWISE SPECIFIED TOLERANCES FOR INCHES ARE:                                             |
| .020 - .315 = ± 0.007"                                                                            |
| .315 - 1.180 = ± 0.015"                                                                           |
| 1.180 - 4.724 = ± 0.020"                                                                          |
| DO NOT SCALE DRAWING                                                                              |

| APPROVALS    | DATE     |
|--------------|----------|
| DRAWN G.R.S. | 06/05/03 |
| CHECKED      |          |
| ISSUED       |          |
| SHEET 1 OF 1 |          |

| CAD FILE          | DWG. NO.   | REV. | SIZE | SCALE |
|-------------------|------------|------|------|-------|
| C:/122/122140.DWG | 122140.DWG | A    | A    | NA    |

**Amphenol Connex**

PART DESCRIPTION: TNC R/A CRIMP PLUG (FOR RG-58/u, 58C/u, 141/u CABLE)

PART NO.: 122140